

7-3/4 (196.85)	10 (254)	5 (127)	5-3/4 (146.05)						3/4 (19.05)
6-1/4 (158.75)	8 (203.2)	3-3/4 (95.25)	4-1/4 (107.95)						1-9/16 (39.68)
5-3/4 (146.05)	6 (152.4)	2-1/16 (52.39)	3-3/4 (95.25)						1-3/8 (34.93)
		MIN.	MAX.						
X	A	B	C	D	E	F	G	H	K
MINIMUM EFFECTIVE HEADER	TRACK RADIUS	HEADER TO TOP OF TRACK	SILL TO HEADER	VERTICAL TRACK	TRACK HEIGHT	POST TO POST	DOOR WIDTH	WALL TO WALL	HANG DOWN

8-1/4 (209.55)	10 (254)	6-1/4 (158.75)							0
7-13/16 (198.44)	8 (203.2)	5-13/16 (147.64)							0
7-1/8 (180.98)	6 (152.4)	5-1/8 (130.18)							0
J	A	B	C	D	E	F	G	H	K
MINIMUM HEADER W/NO HANG DOWN	TRACK RADIUS	HEADER TO TOP OF TRACK	SILL TO HEADER	VERTICAL TRACK	TRACK HEIGHT	POST TO POST	DOOR WIDTH	WALL TO WALL	HANG DOWN

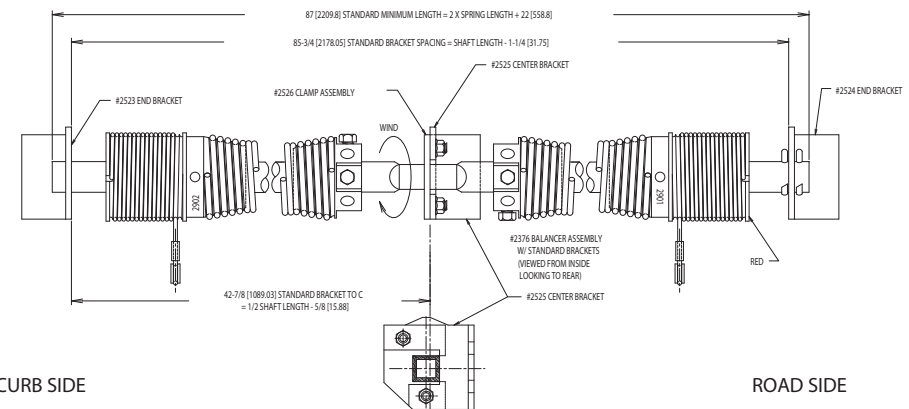

CURB SIDE

ROAD SIDE

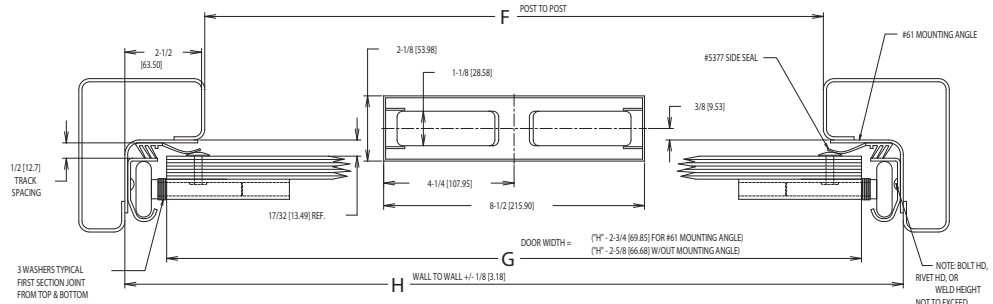

3 WASHERS TYPICAL FIRST SECTION JOINT FROM TOP & BOTTOM 4 LOCATIONS TOTAL FOR 1/4 (6.35) - 3/8 (9.53) OF SIDE SHAFT

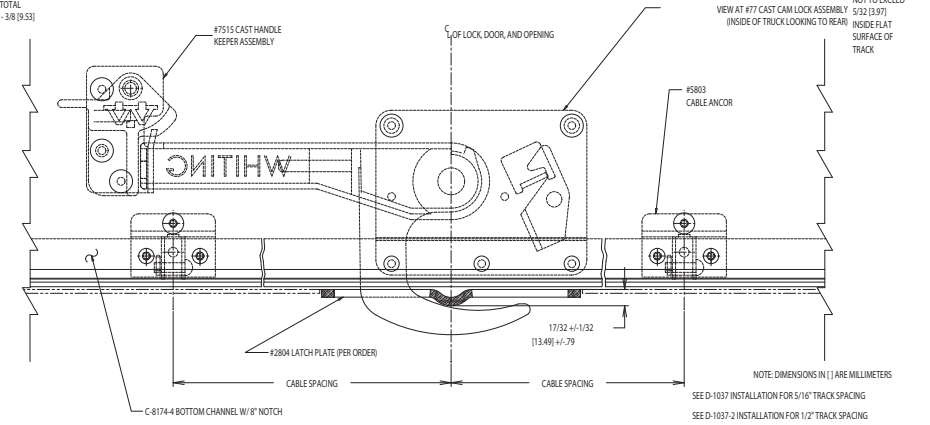

11/23/02	D	REDOOR OPENING WIDTH TOLERANCES & ROLLER WASHER NOTE	MIS	DCW	TOLERANCES UNLESS OTHERWISE SPECIFIED ARE:	WHITING DOOR MANUFACTURING LTD. 3435 SOUTH SERVICE ROAD BURLINGTON, ONTARIO L7N 3W6	TITLE	STANDARD INSTALLATION FOR LICENCES			
11/23/02	C	REVISED AND UPDATED FOR CURRENT SPECIFICATIONS	MIS	DCW	FRACTION: 1/16 ANGLES: 1/2"		3/4" PREMIUM DRY FREIGHT DOOR				
1/27/98	B	UPDATED AND REWORK ON CAD	MIS	DCW		1/2" TRACK SPACING					
1/25/94	A	INSTRUCTIONS ADDED	DHL	CAP							
DATE	BY	DESCRIPTION OF CHANGE	AUTH	DR	DO NOT SCALE DRAWING	DRAWN BY	DATE	CHECKED	SCALE	DWG. NO.	REV.
		REASON				DCW	11/02		1/2" = 1"	D-1037-1	D

NOTE: DIMENSIONS IN [] ARE MILLIMETERS
SEE D-1037-2 INSTALLATION FOR 5/16" TRACK SPACING
SEE D-1037-2 INSTALLATION FOR 1/2" TRACK SPACING