

# **INSTALLATION INSTRUCTIONS - TAMBOUR CONFIGURATION**

29-NOV-2016

Rev. 2

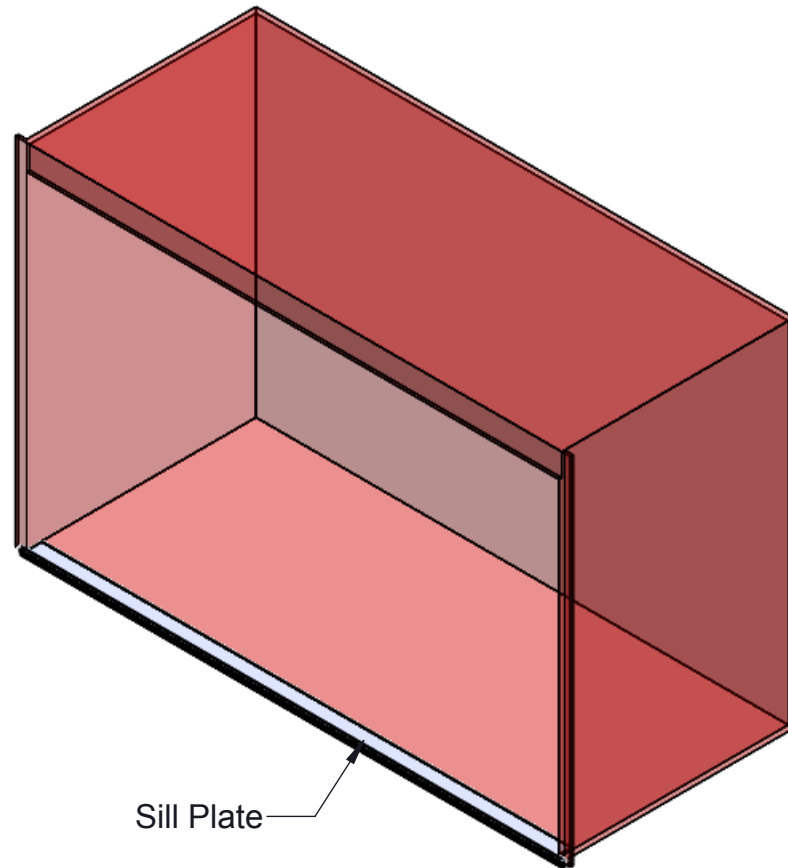

Fig. 1

## **Step-1: INSTALL SILL PLATE**

Install Sill Plate (optional) as shown in Fig.1. Otherwise proceed to Step-2.

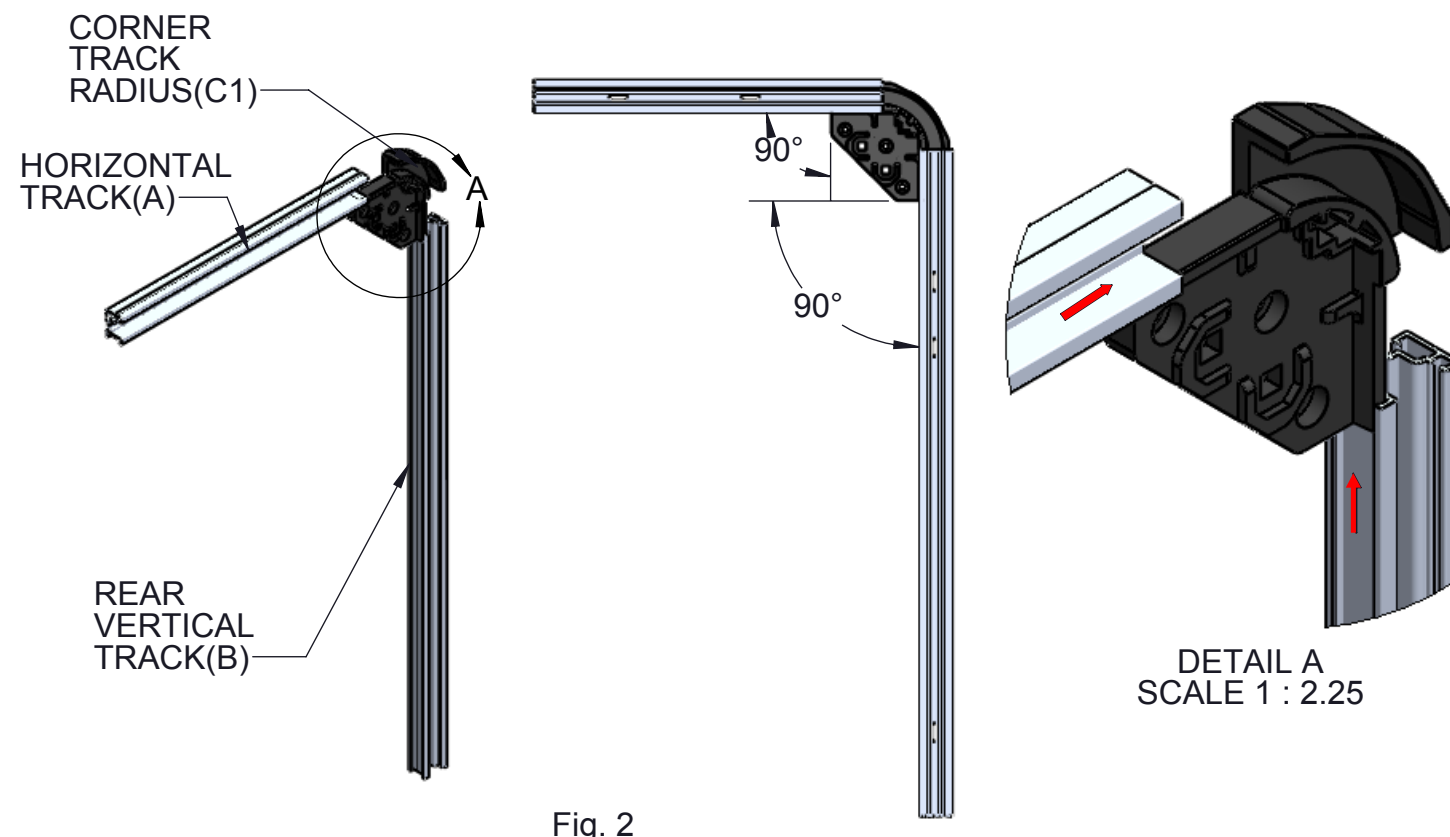

Fig. 2

## **Step-2: INSTALL REAR CORNER RADIUS(C1), HORIZONTAL TRACK(A), REAR VERTICAL TRACK(B)**

- Slide Horizontal Track(A) and Rear Vertical Track(B) over the Corner Track Radius(C1) (Fig. 2 & DETAIL A).
- Place all three components flush to the left side wall as shown in Fig. 3 on the following page. Ensure that the Rear Vertical Track(B) is registered to the floor and both the tracks are perpendicular to Corner Track Radius(C1).
- Apply masking tape to hold Horizontal Track(A) and Rear Vertical Track(B) temporarily in place.
- Slide Corner Track Radius (C2) along with Side Frame (D) under the Horizontal Track (A) and register Side Frame (D) to the exterior face of the body. Ensure that the Side Frame is properly seated against exterior face of the body and perpendicular to the Corner Track Radius (C2). Apply the tape to hold the Side Frame (D).
- Use a small level to ensure true vertical and horizontal positions of Tracks (A & B) and Side Frame (D).
- Mark holes on compartment wall using holes on Corner Track Radius (C1), Horizontal Track (A) and Inner Vertical Track (B) as a guide. Drill the holes. Secure Corner Track Radius, Horizontal Track and Inner Vertical Track with screws.
- Remove the tape.
- **NOTE:** Secure both tracks (A & B) using low profile pan head screws. Ensure that the screw heads are flush and do not protrude into door track causing possible interference.
- Follow the same procedure as mentioned above for installing Horizontal Track, Rear Corner Track Radius and Rear Vertical Track on right side wall (Fig. 4).

### **Components (refer to Fig. 3):**

**A - Horizontal Track**

**B - Rear Vertical Track**

**C1 - Corner Track Radius Rear**

**C2 - Corner Track Radius Front**

**D - Side Frame (Outer Vertical Track)**

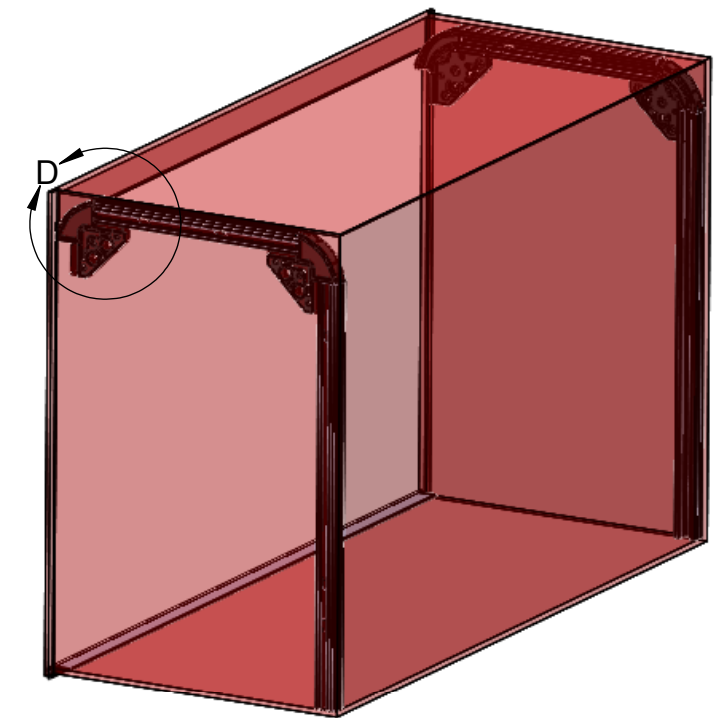
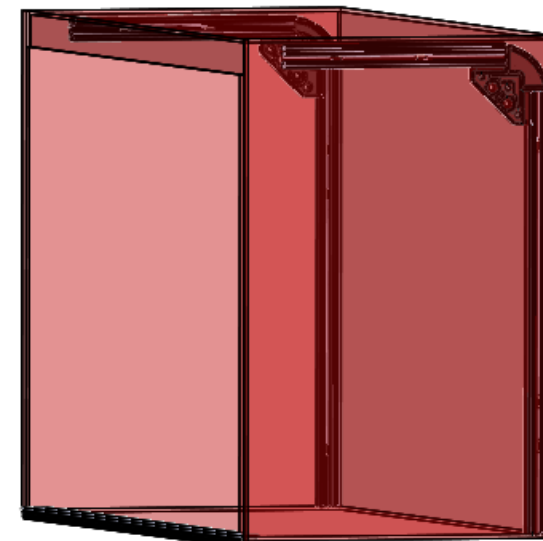
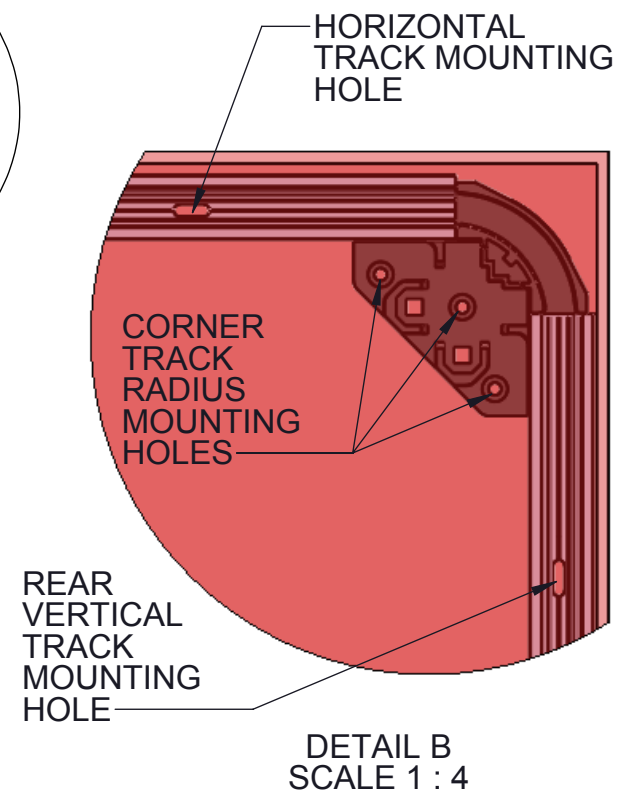
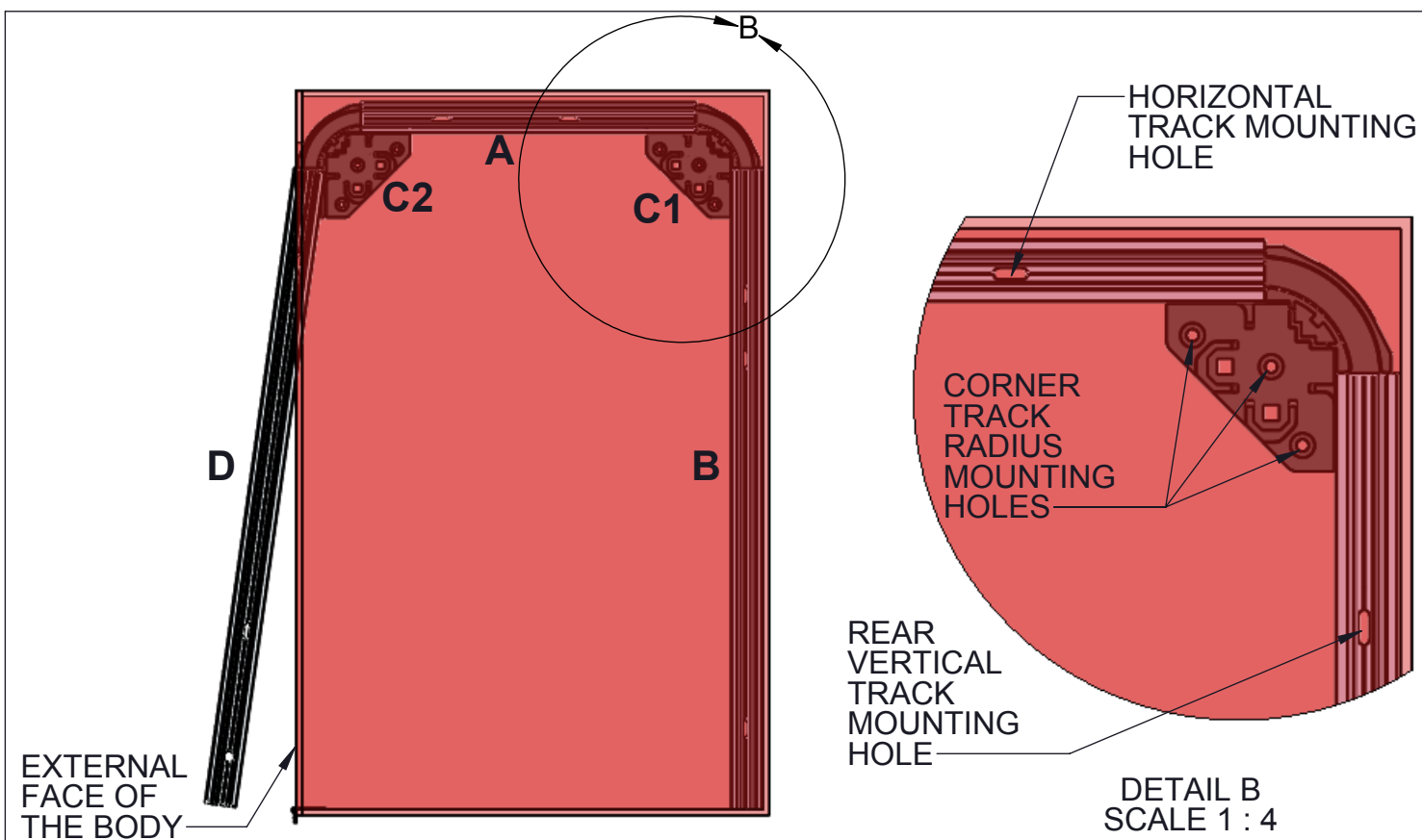

### **Step-3: INSTALL FRONT CORNER RADIUS(C2)**

Slide the Corner Track Radius (C2) under the slot in Horizontal Track (A) on left side (Fig. 5 & DETAIL C). Ensure that the Corner Track Radius (C2) is perpendicular to the Horizontal Track (A). Mark the holes on compartment wall using holes on Corner Track Radius as a guide. Drill the holes. Secure the Corner Track Radius (C2).

Follow the same procedure as mentioned above and install the Corner Track Radius (C2) on right side (Fig. 6 & DETAIL D).

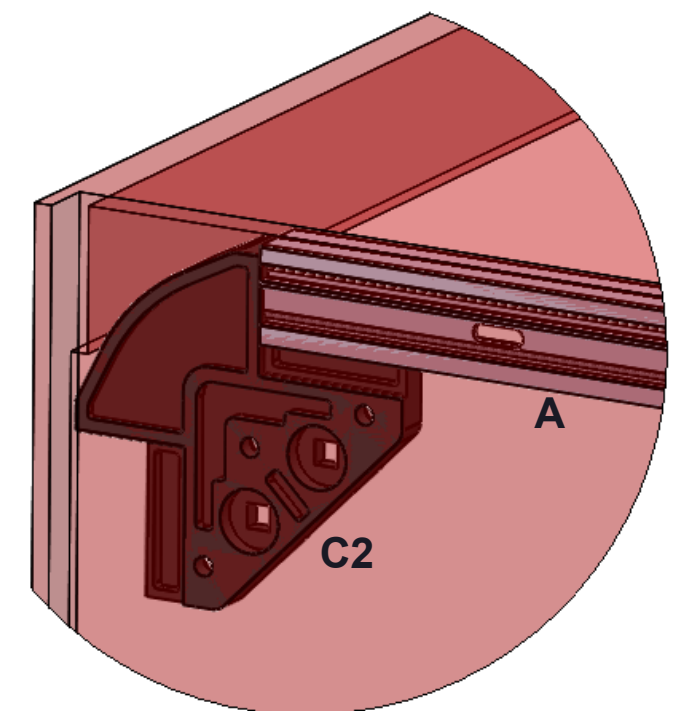
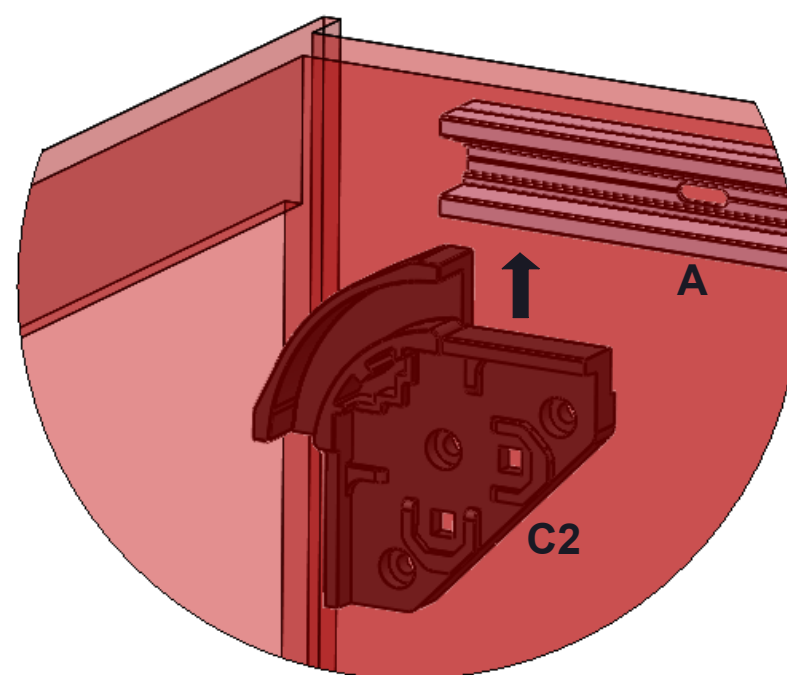
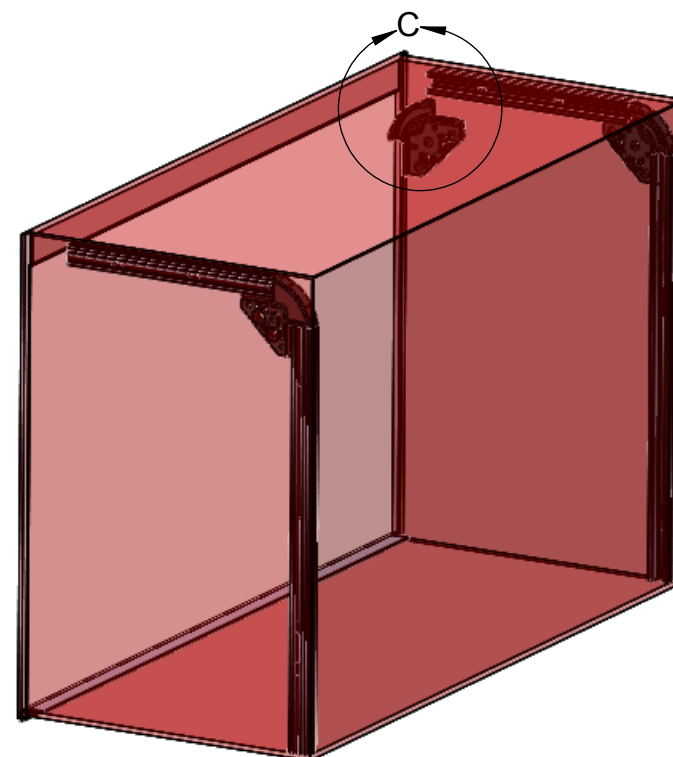



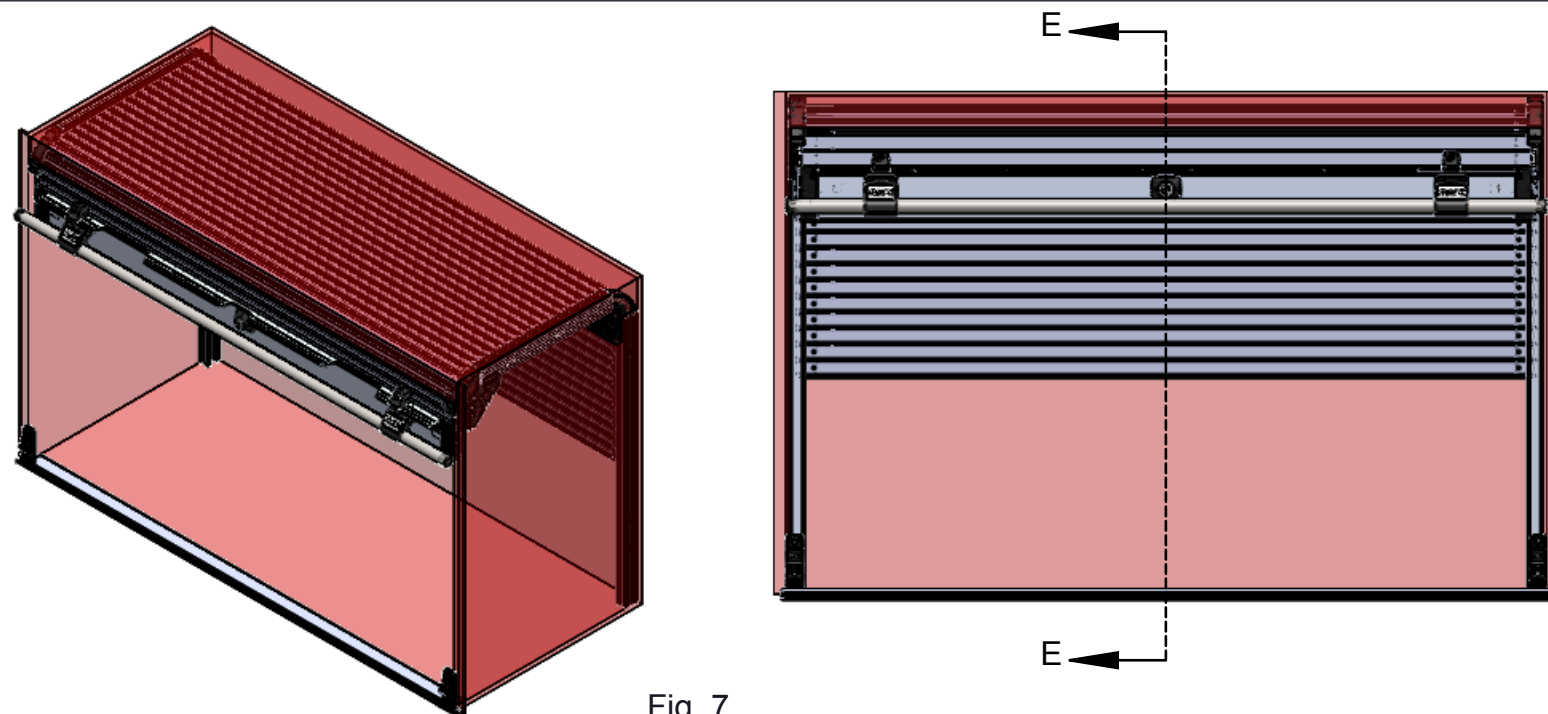

Fig. 7

#### **Step-4: INSTALL DOOR CURTAIN**

Roll the door curtain through the Corner Track Radii and Horizontal Tracks (Fig. 7, Section E-E and DETAIL F). Feed as much of the door curtain as possible into horizontal and rear vertical tracks.

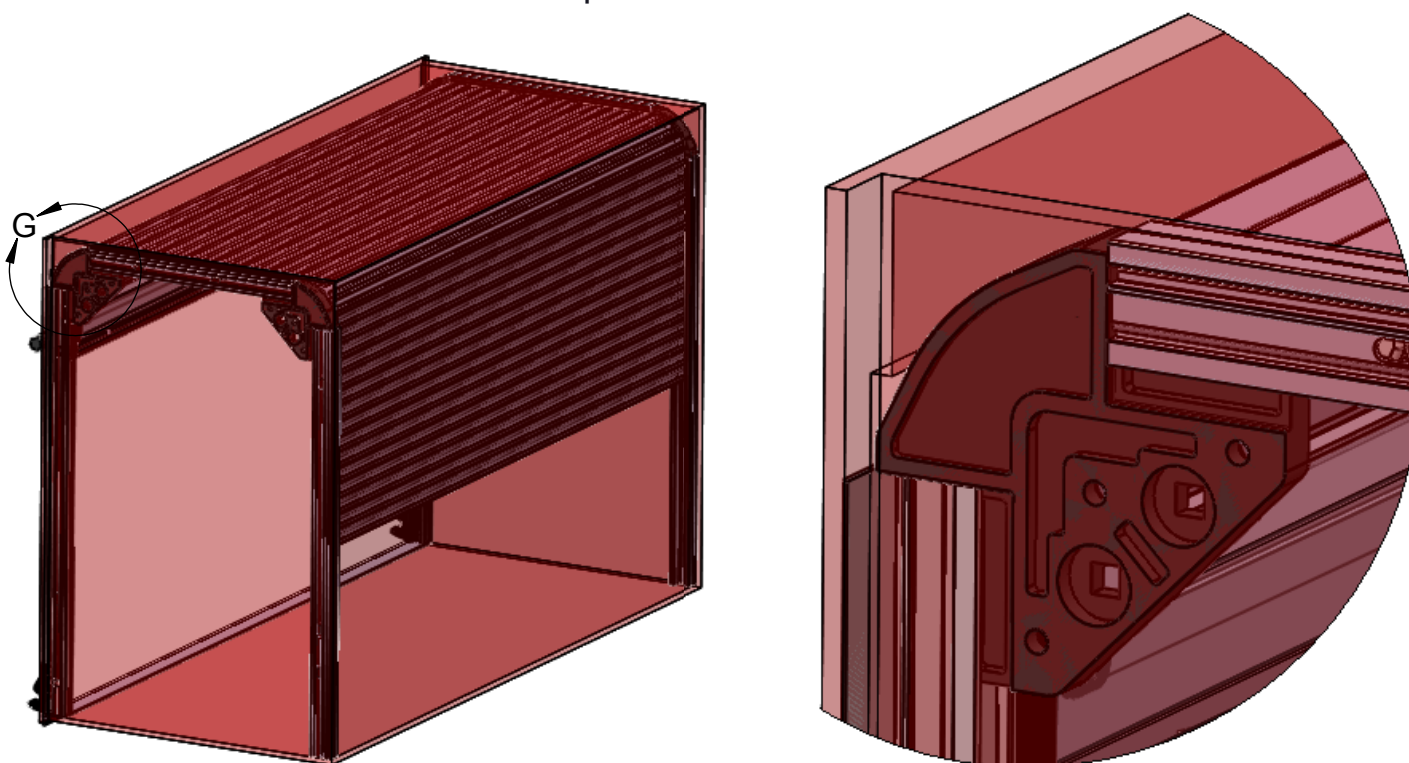
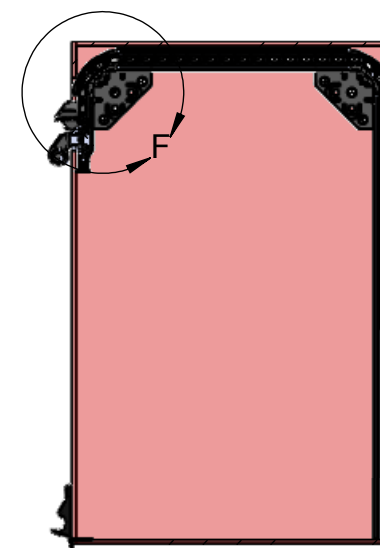

Fig. 8

DETAIL G  
SCALE 1 : 2

#### **Step-5: INSTALL SIDE FRAMES**

Lift Bottom Panel and slide both Side Frames in place. Ensure that both Side Frames are seated well on Corner Track Radius (C2) and flush against exterior face of the body (Fig. 8 and DETAIL G). Mark the holes on compartment wall using holes on Side Frames as a guide. Drill the holes. Secure the Side Frames with low profile pan head screws. Ensure that the screw heads are recessed within fastener channel to avoid end shoe interference during operation.



SECTION E-E  
SCALE 1 : 12

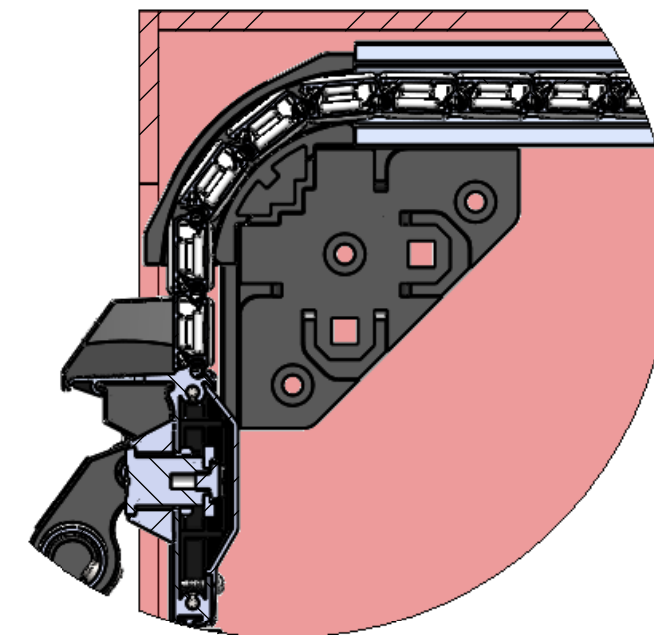

DETAIL F  
SCALE 1 : 2.5

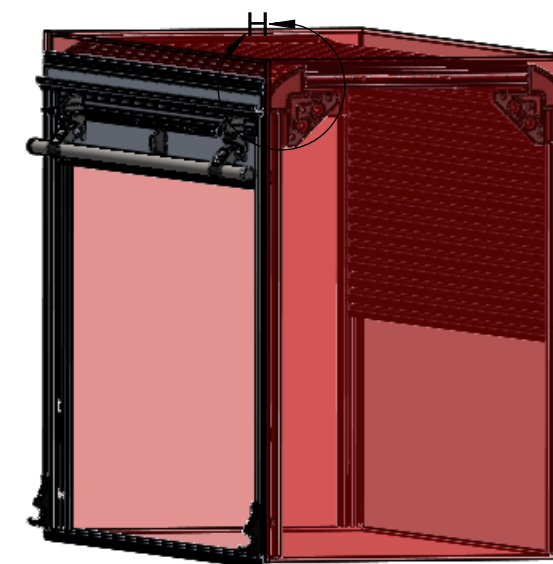

Fig. 9

#### **Step-6: INSTALL TOP GUTTER**

Place the Top Gutter onto the top edge of both side frames. Drill holes and secure in place with screws (Fig. 9 and DETAIL H). Screws should not protrude more than 1/8" into compartment.

**CAUTION:** Fasteners protruding more than 1/8" behind header will damage door face.

Install top gutter screw cover. Apply low fume, low odor exterior grade adhesive on back face of end caps and insert end caps into each end of screw cover. Insert small lower end plugs.

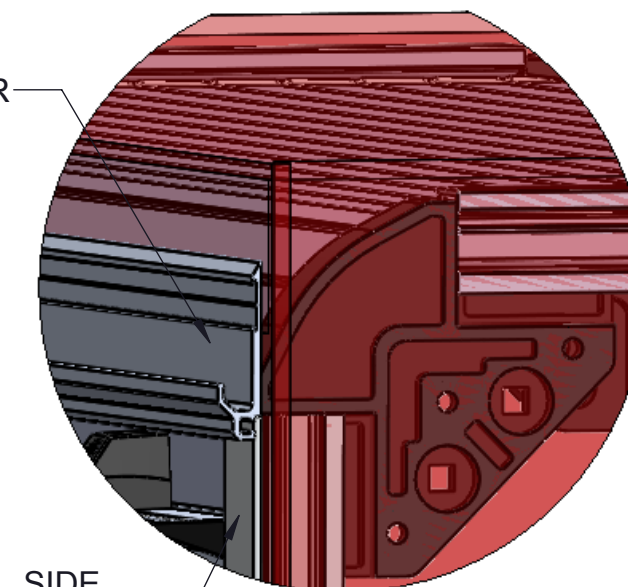

DETAIL H  
SCALE 1 : 2.5